

Interior Style Advice service

Client: XXXX XXXXXXXX

Reader question

I have recently purchased a new house which has a large open plan kitchen/living room. I am keen for some advice on the colours and flooring that we should use in this large, light room. We will be replacing the kitchen and at this stage we are thinking of buying a cream shaker style kitchen, although I would be keen to know your thoughts on the style of kitchen we should have. We will also be changing all the flooring. The walls are currently a creamy colour. We will be getting a new sofa and rug for the floor (style and colour not yet determined), so essentially we have a blank canvas. We plan to take down the curtains and have no curtains or blinds in the living room.

I have seen light grey/white oak flooring that I like the look of, but I am not sure how this would look with the exposed wood beams. We would like to paint the whole room, but uncertain what colour. I don't really like pinky creams or light yellowy colours. Possibly even have wall paper on the side of the wall where the fireplace is? We are keen to have built-in book shelves either side of the fire place, with cupboards at the bottom. I should also say we have a 1 year son, so we can't have anything too impractical or flooring that is too slippery, for example.

In summary, I would be keen for your advice on colours for the walls, type of flooring (wood? stone?), kitchen style and colour, shelving and possibly sofa and rug colours/styles.

I have attached 3 photos and links to further pictures.

<http://www.chancellors.co.uk/Search/property/FullDetails.aspx?searchmode=B&instructionid=1305538&instructiontype=SAL&propref=15410PAE®office=154&offmode=R&maintoff=0&instrno=0&siteid=0&weekmonth=M>

Our advice

Thank you for using our online Interior Style Service, you have a great space to work with and so it was a lovely project for us. Based on the information you have provided, we have put together three different looks for you to consider.

Shaker Style

In your email, you mentioned that you had seen a Shaker style kitchen and so this is the first look we have put together. I wanted to demonstrate that a white oak floor can sit comfortably next to a shaker kitchen, as it will help to make the space feel bigger and brighter. When you come to choose your floor, steer towards a very pale white oak as some ranges can be quite dark. The floor will be fine for young children and a much softer option than stone.

Patterned wallpaper on the chimney breast is a good idea and a great way to create a focal point. We have chosen a delicate Dandelion design from Wallpaper Direct, but any similar pattern will work as long as you stick to cream, white and pale blue/grey.

I would recommend cream or a pale grey; if you want a colour then a soft blue grey would also work. Pick out colours from your wallpaper and carry this through to your cushions, combine these with some typical shaker style designs with signature hearts, finish the look with a chunky knit throw in pale grey.

Introduce pattern to the scheme with your rug, sticking with the pale blue/grey and cream palette. As this is a big space, you can afford to have a large rug; this will help to divide up the kitchen space, designating different areas for eating, cooking and socialising. If you are planning on buying a coffee or dining table, then let the rug act as a decorative border, leaving about a foot from the bottom of the table to the edge of the rug.

For the walls, I would recommend cream/white, try Farrow & Balls Blackened 2011, paint your shelves the same colour so that blend seamlessly with the wall. If you would rather have a colour on the walls then look at 'Skylight 205' & Pale Powder 204', both Farrow & Ball.

Good places to buy shelving systems are Bo Concept, Ikea and Vitsoe.

Summary

Colours: grey/blue, cream & white

Furniture: Cream sofa teamed with white Painted wood

Accessories: Pale painted wood & white ceramic

Soft furnishings: Pale grey/blue patterns teamed with cream & white in wool

Industrial

This look will lend itself perfectly to your space as you have the beautiful exposed beams. I know that you were concerned as to how they would work within the scheme but they will be an important & stylish feature of the room. They can stay as they are or you could paint them white, it will all depend on how 'industrial' you want the kitchen to be.

For your shelving, consider a wood and metal system or, warehouse racks as they are sometimes called, as seen in the picture. Make sure the bottom shelves are high enough to be out of reach of your little one. The sofa we have chosen has a wooden base with cushions upholstered in an olive green. Other colours that could be used are varying shades of grey, putty and chocolate. The sofa doesn't have to have a wooden base but it will need to be a with linear design; Google 'Danish sofa styles' for inspiration

Most High Street stores are producing copycat designs now.

You can afford to be clever with the floor, whilst concrete is trendy, looks great and is inexpensive to use, it is not ideal for young children as it is so hard under foot. Instead, cheat a little and consider a vinyl floor with a concrete design, it is very affordable, easy to clean and soft underfoot for children. It is also relatively easy to replace further down the line when the children are a little older.

A good rug for this scheme would be sisal. Choose a dark colour for the border such as slate grey or dark chocolate. Accessories include enamel pendant lights, glass storage jars, and wooded utensils.

Summary

Colours: Grey, olive green & cream

Furniture: Dark wood, silver metal

Accessories: Wood, glass & enamel

Bright Kitchen

This is a bright and fresh scheme that is very 'on trend'. The units are white high gloss, teamed with a pastel colour for the worktop. If this isn't to your taste then a white or Black surface will suffice.

Go for a plain colour with your sofa and add pattern with the cushions, using other colours you have introduced around the kitchen. I would recommend a sisal rug with coloured border that compliments the sofa. Other option would a cut pile woollen rug.

A fantastic floor for this scheme would be a high gloss liquid resin, it can be quite pricey but it's durable, easy to clean and looks super stylish. A cheaper option would be white rubber which is softer under foot or you could look at high gloss ceramic tiles, hard wearing and easy to clean but can be quite a hard surface for little ones. One idea, would be to install under floor heating which would make a huge difference in the winter months.

Steer towards off-white paint for the walls, Kelly Hoppen and Zoffany paints have a good selection of colours. Again, paint the units in the same colour.

Summary

Colours: White, brights such as lime, fuchsia & cobalt blue (maximum 2-3 brights colours at once)

Furniture: White melamine, high gloss, metal

Accessories: Brights, Clear glass and metal

Directory

Kitchen companies: John Lewis, B&Q, KBBC Kitchens, Magnet, Everest

Shelving: Ikea, Bo Concept, Ligne Roset

Sofas: Sofa Workshop, Sofa.com, Heals, BHS, Next, John Lewis

Rugs: Roger Oates, Laura Ashley, John Lewis, Ikea

Paint: Zoffany, Kelly Hoppen, Farrow & Ball, Dulux Heritage range

Accessories: Joseph Joseph, Graham & Green, Cox & Cox, Divertimenti, John Lewis

Shaker Style

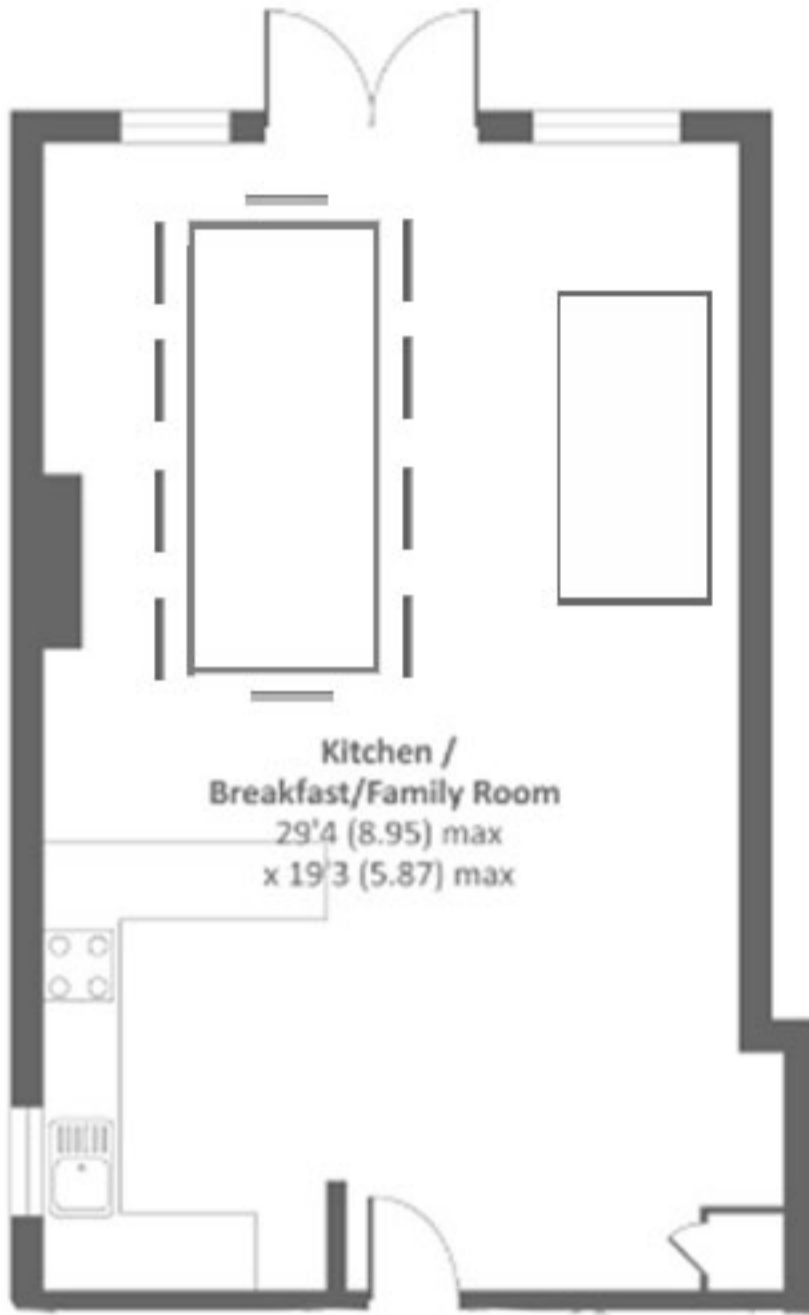

Wallpaper: *Dandelion Mobile*
£55.00 per roll, MISP1023, Wallpaper
Direct



Flooring: Pergo Original Excellence
Plank 4v Distressed White Oak, plank
Laminate Flooring, Pergo

Accessories: Shaker acces-
sories from Live, Laugh &

Paint: Blackened
2011, Farrow & Ball

Cushions: from a
selection at Heals

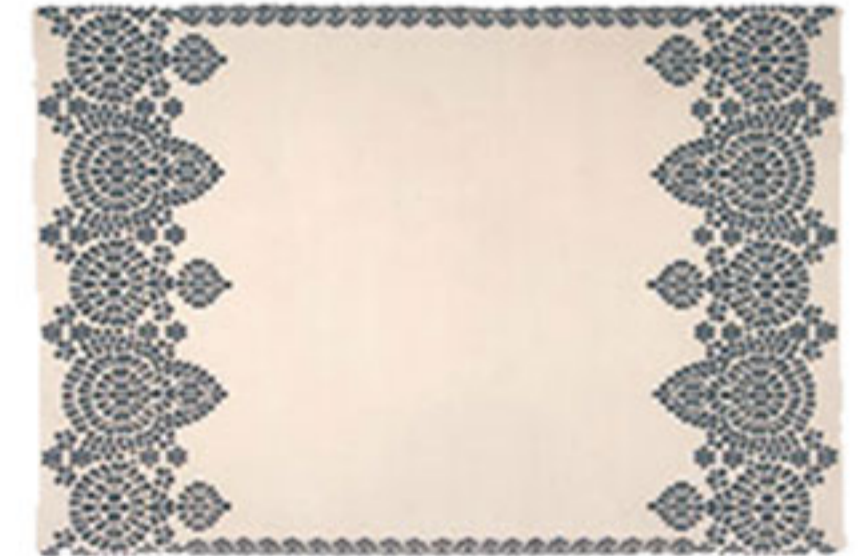
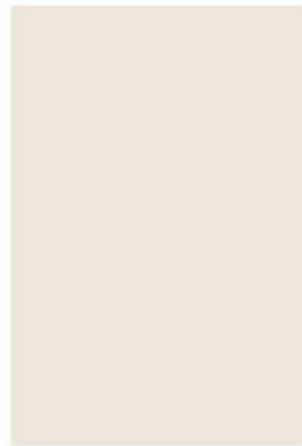

John Lewis Infinity Grand Sofa, Harlequin Dune
£2,400

Modern & Bright kitchen

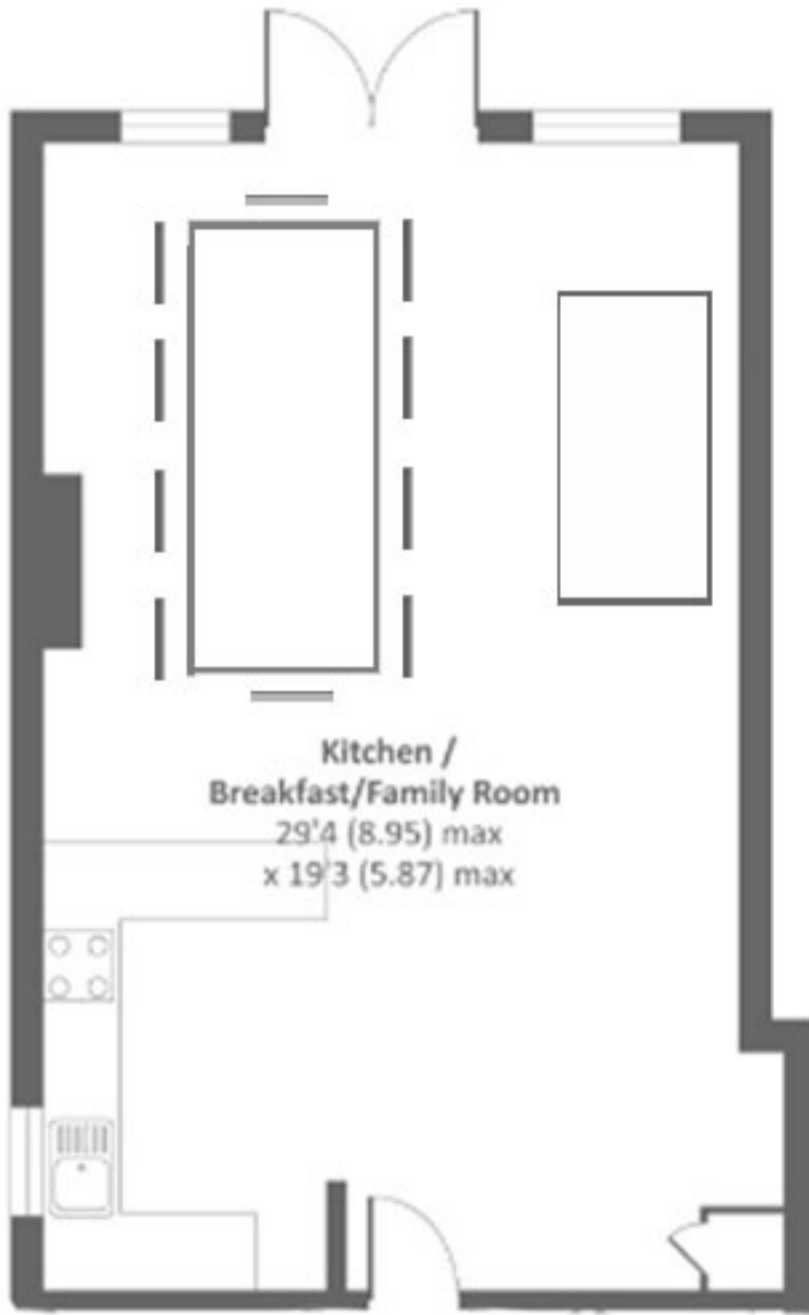

Kitchen style: This is a good example of how exposed beams can look fantastic with a white oak floor and white units

Units: The kitchen units could still be Shaker style but you could be a little creative with the worktops by opting for a colour (image above).



Cushions: from a selection at Heals



Floor options: white High Gloss laminate floor, Homebase, Poured resin high gloss floor from Senso flooring (image to the right) or light white oak floor (top right images)



Rug: Sisal rug with colored border

Wall colour: Off-white with a touch of putty. Kelly Hoppen Paints & Zoffany have a good selection

Shelving: built in shelving (image to the right), I would recommend MDF painted in the same colour as the walls - try a local carpenter/builder



Sofa: John Lewis Barbican Medium Sofa, Cossette Green / Dark Leg £1,100



Industrial kitchen

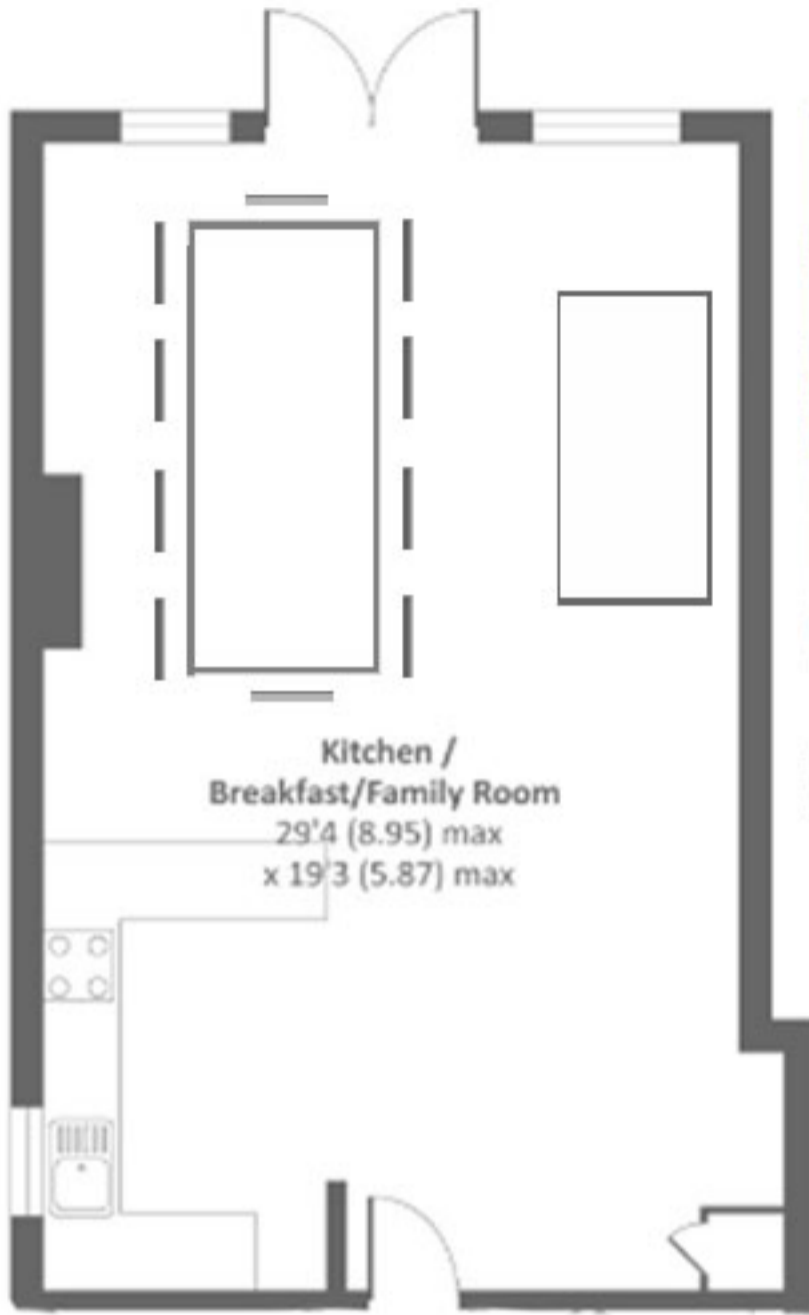

Shelving: Wooden & metal shelving system to display ornaments and kitchenware

Lighting: Enamel Pendant light: Ecrater.co.uk or Tesco for cheaper option



Kitchen chairs: Industrial kitchen chairs, Home Barn Shop.co.uk



Flooring: Vinyl flooring; Spacia Industrial Concrete SS5S3568 Flooring Supplies.co.uk

Paint: Elephants Breath, Farrow & Ball



Retro sofa: similar found at Heals, BHS, The Sofa Workshop

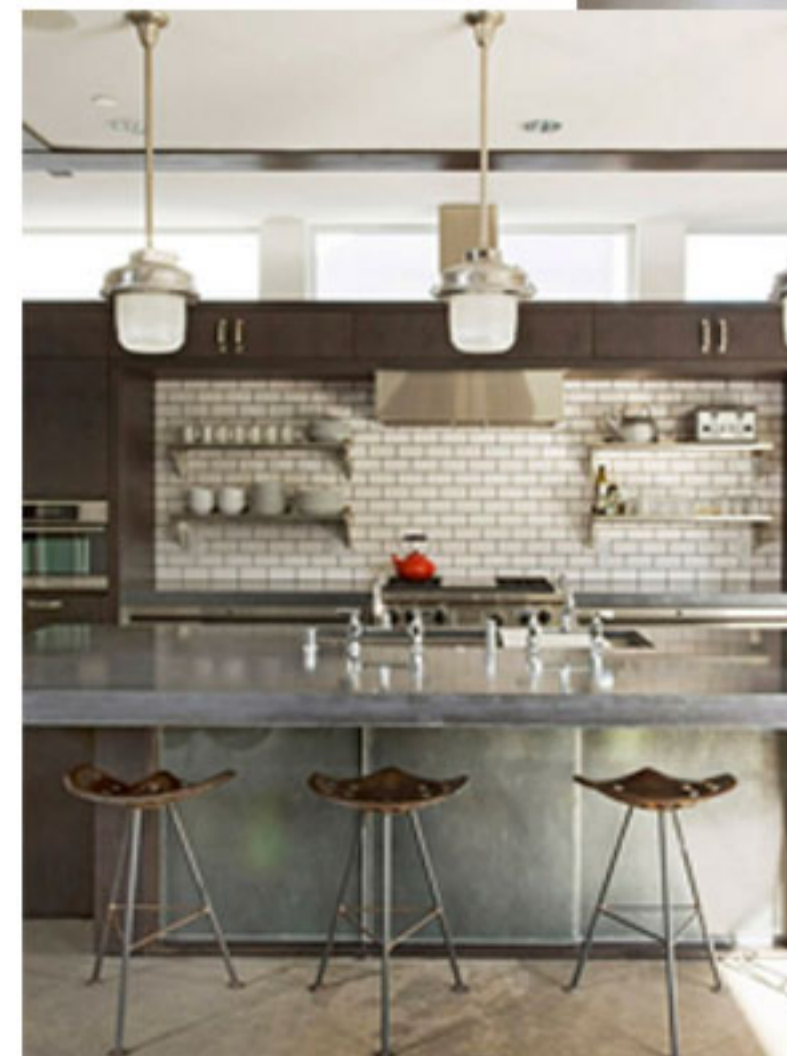

Rug: Sisal as in picture below, B&Q or Overstock.com

